

NOTE: BREAK ALL CORNERS WITH 0.015" (.38 MM) RADIUS UNLESS OTHERWISE SPECIFIED. STANDARD TOLERANCES TO APPLY UNLESS OTHERWISE SPECIFIED.

CUSTOMER	CAN ART STD.	DIE No.	ES05927	REV. No.	1
DESCRIPTION	1 x 2 x .125 CHANNEL	CUSTOMER PART No.	QUOTE No.	PROPOSAL No.	
			09-0191-1	S-20419	

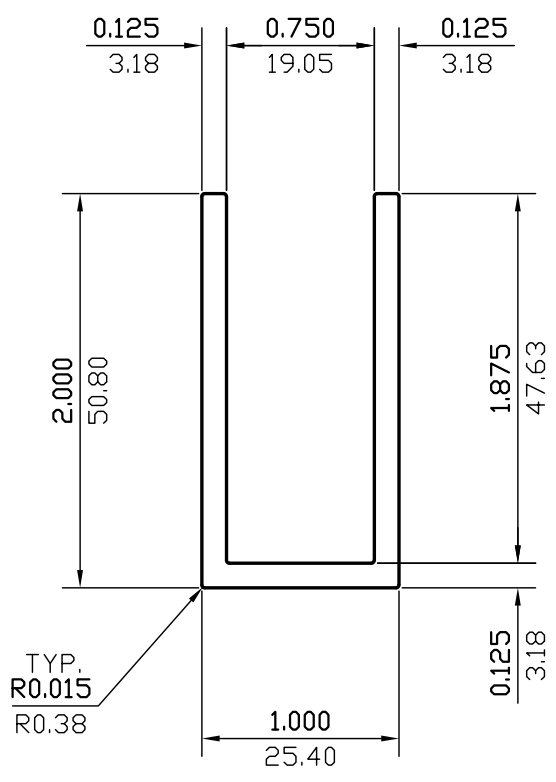

WALL THICKNESS 0.125(3.18) EXCEPT AS SHOWN

DATE	REV	DESCRIPTION	BY
03/20/23	1	REMOVED ALLOY	JASDN
EST. AREA	0.594	IN. <sup>2</sup>	EST. AREA
			382.942
			MM. <sup>2</sup>
EST. WT.	0.700	LBS/FT.	EST. WT.
			1.042
			KG/M.
EST. PER.	9.698	IN.	EST. PER.
			246.342
			MM.
OUT PER.		IN.	OUT PER.
C.C.D.	2.223	IN.	C.C.D.
			56.459
			MM.
FINISH	M/F		ALLOY
CKD BY	FACTOR 14	SCALE 1:1	DWN BY C.P. DATE 02/17/2009

# CAN ART

ALUMINUM EXTRUSION INC.

85 PARKSHORE DRIVE  
BRAMPTON, ONT L6T 5M1  
TEL. NO. (905) 791-1464  
FAX NO. (905) 791-9151  
WEB: www.canart.com

THIS DRAWING IS NOT NECESSARILY A COPY OF YOUR ORIGINAL. PLEASE APPROVE DIMENSIONS AND TOLERANCES INDICATED. CAN ART ASSUMES NO RESPONSIBILITY EITHER TECHNICAL OR LEGAL FOR HAVING THIS SHAPE MADE. THE CUSTOMER AGREES TO FULLY PROTECT CAN ART ALUMINUM FROM CLAIMS OF OTHERS RESULTING FROM THIS SHAPE.

SIGNED: \_\_\_\_\_ DATE: \_\_\_\_\_